

TF-450HC



GARDNER DENVER
WATER JETTING
SYSTEMS, INC.

Pressures to 20,000 PSI
Flows to 54 GPM ♦ Power to 330 HP

Fast & Affordable Convertibility

Features:

- ♦ Pressure/flow convertibility from well of pump. Does not require unbolting and retorquing.
- ♦ No valve change required.
- ♦ Inline fluid end design.
- ♦ Pressure range from 10,000 PSI to 20,000 PSI.
- ♦ Flow rates from 10 GPM to 54 GPM.
- ♦ Maximum frame load of 20,750 Lbs. / 9420 Kg. for multi-speed, and 18,000 Lbs. / 8165 Kg for single speed.
- ♦ Field proven design.
- ♦ Easy field maintenance.
- ♦ Stainless steel fluid end construction.
- ♦ High volumetric efficiency for maximum horsepower utilization.
- ♦ Rigorously subjected to full load testing.
- ♦ Manufactured on state-of-the-art machinery.

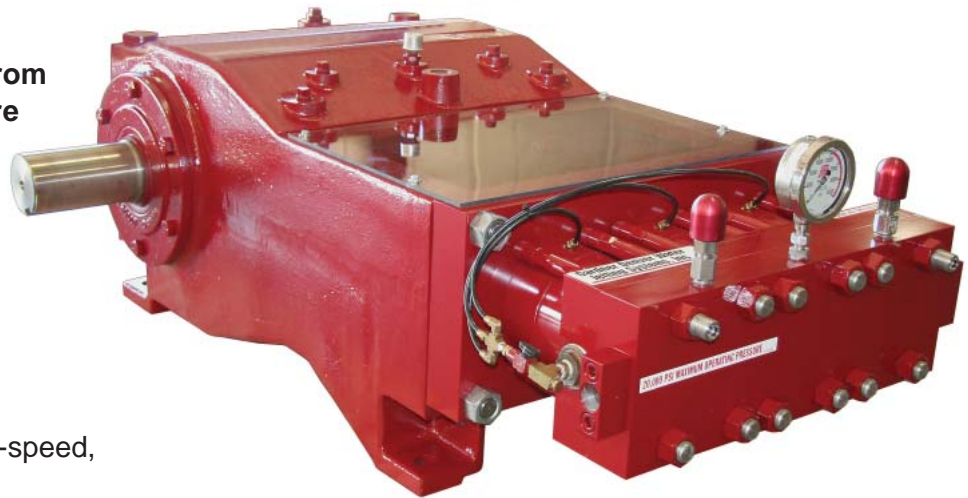

Applications:

- ♦ Water Blasting
- ♦ Concrete Demolition
- ♦ Surface Preparation
- ♦ Hydrostatic Testing
- ♦ Water Disposal

Performance Specifications:

	PLUNGER DIA.	MAX. PRESSURE		FLOW					
		PSI	Bar	200 RPM		400 RPM		500 RPM	
				GPM	LPM	GPM	LPM	GPM	LPM
TF-450HC	1.062" - 26mm	20K	1379	10	37.9	21	79.5	26	98.4
	1.250" - 32mm	15K	1034	14	53.0	29	109.8	36	136.2
	1.375" - 35mm	12K	827	17	64.3	34	128.7	43	162.8
	1.500" - 38mm	10K	689	21	79.5	42	159.0	52	196.8

Stroke: 4.5" / 114 mm • Max. Speed: 515 RPM • Weight: 2,600 lbs. / 1179 Kg

GARDNER DENVER WATER JETTING SYSTEMS, INC.

Partek • Liqua-Blaster • CRS Power Flow • Jetting Systems • American Water Blaster

1-800-231-3628 ♦ 281-448-5800 ♦ Fax: 281-448-7500

www.waterjetting.com ♦ E-mail: mktg.wjs@gardnerdenver.com



GARDNER DENVER

TF-450HC

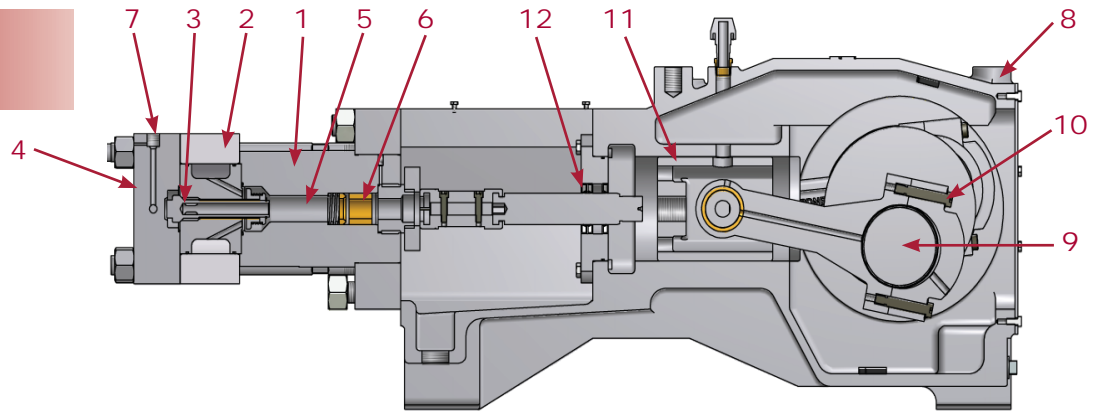

Fluid End

1. Stuffing Boxes: Three boxes machined from hardened stainless steel for extended life.
2. Suction Manifold: Hard, anodized aluminum. Also available in stainless for salt water applications.
3. Valve Assembly: Hardened stainless steel, autofretaged for extended life. Valves are spring-loaded for positive closing with a common seat used for both suction and discharge valves.
4. Discharge Manifold: Manufactured from precipitation hardened stainless steel.
5. Plungers: Made of solid tungsten carbide or stainless steel with colmonoy coating.
6. Plunger Packing: Carbon filled Teflon™ and polyethylene base, spring-loaded, self-adjusting and easily replaceable from the rear of the stuffing box. Force-fed water provides lubrication and cooling.
7. Pressure Relief: Pressure safety head assembly (two rupture discs), mounted to the discharge manifold.

Power End

8. Power Frame: Manufactured from a single piece casting of high strength gray cast iron.
9. Crankshaft: Single extended steel with tapered roller bearings to minimize side thrust load.
10. Connecting Rods: Ductile iron with automotive type split insert bearings.
11. Crossheads: Large, piston type constructed of gray iron.
12. Diaphragm Seals: Installed with o-rings or gaskets and neoprene oil seals.

Utilizes a belt or poly-chain drive system.

Bearings and crossheads are oil lubricated with a combined splash gravity system that insures adequate circulation at speeds as low as 200 RPM.

Dimensions:

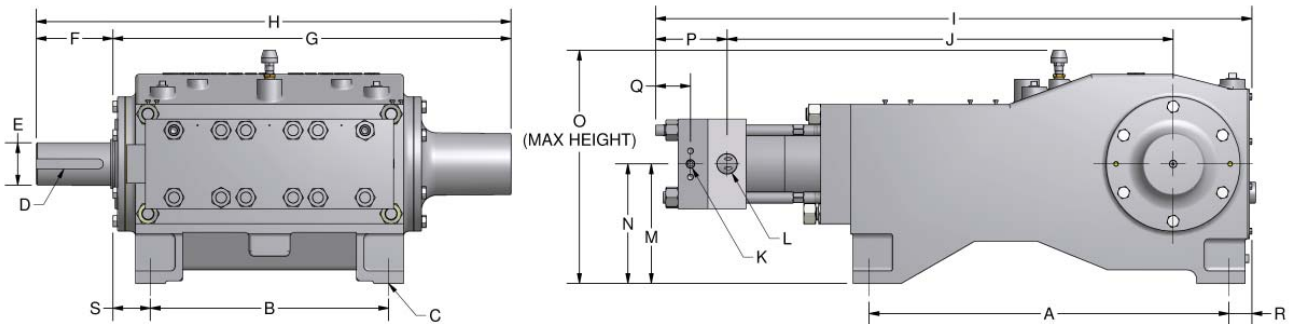

	A	B	C	D	E	F	G	H	I	J	K	L	M	N	O	P	Q	R
In.	36 ¹ / ₄	24	1 ⁵ / ₁₆	1	4 ¹ / ₄	7 ³ / ₄	40 ¹ / ₈	47 ⁷ / ₈	60	45	1" MP	2" NPT	12	12	23 ³ / ₈	7 ¹ / ₄	3 ¹ / ₂	2 ¹ / ₄
mm	921	610	33	25	108	197	1019	1216	1524	1143			305	305	594	184	89	57

GARDNER DENVER WATER
JETTING SYSTEMS, INC.
12300 North Houston Rosslyn Road
Houston, TX 77086

Your local distributor/representative is:



GARDNER DENVER WATER JETTING SYSTEMS, INC.

Partek • Liqua-Blaster • CRS Power Flow • Jetting Systems • American Water Blaster

1-800-231-3628 ♦ 281-448-5800 ♦ Fax: 281-448-7500

www.waterjetting.com ♦ E-mail: mktg.wjs@gardnerdenver.com